



FURSECROFT,
MARYLEBONE, W1H
Asking Price £2,495,000 Leasehold

T. +44 (0) 20 7935 0011
E. enquire@napierwatt.co.uk
WWW.NAPIERWATT.CO.UK

NAPIER WATT
PROPERTY CONSULTANTS

Description

A stunning interior designed, three double bedroom, three bathroom fourth floor (with lift) apartment set within a popular portered block. This property has been refurbished to an exacting standard. It is conveniently laid out to offer maximum comfort in a sumptuous home. The property is located on the corner of Brown and George Street and is superbly located for local amenities and transport links of Edgware Road, Baker Street, Marylebone and Hyde Park and a short walk to Paddington and Marylebone Station.

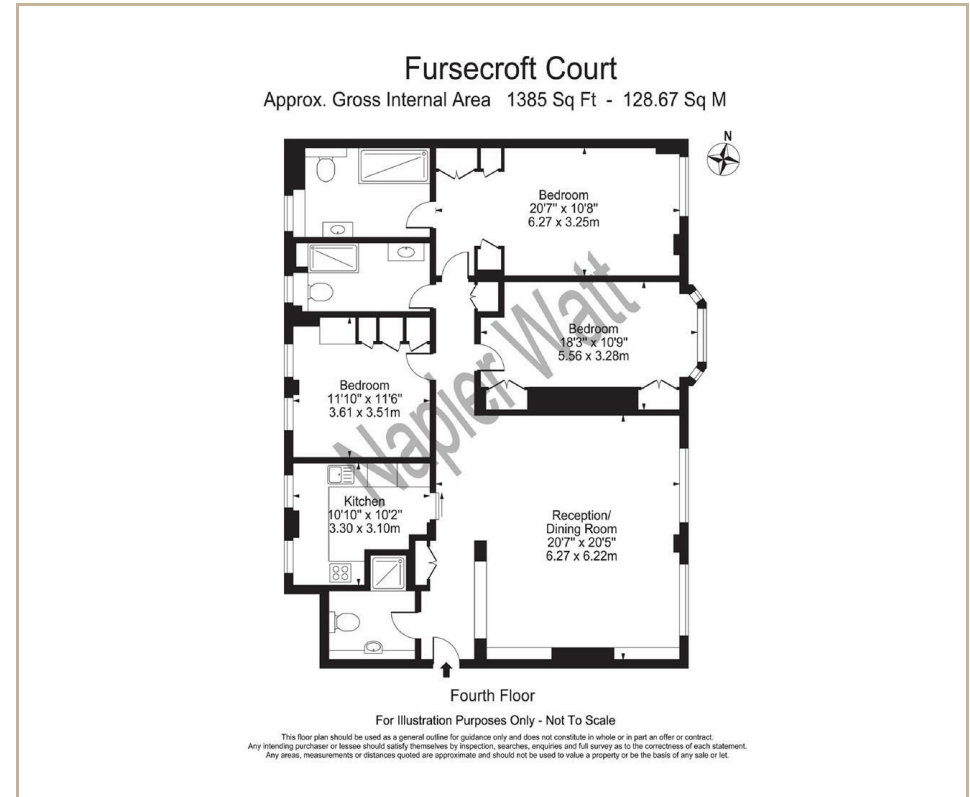

TERMS

Leasehold Approx. 103 Years Remaining
Ground Rent £70 Per Annum

For Clarification we wish to inform prospective purchasers that we have prepared these sales particulars as a general guide. We have not carried out a survey, nor tested the services, appliances and specific fittings. Room sizes are approximate and rounded: they are taken between internal wall surfaces and therefore include cupboards/shelves, etc. Accordingly, they should not be relied upon for carpets and furnishings. Formal notice is given that all fixtures and fittings, carpeting, curtains/blinds and kitchen equipment, whether fitted or not, are deemed to be removable by the vendor unless specifically itemised within these sales particulars.

T. +44 (0) 20 7935 0011
E. enquire@napierwatt.co.uk
WWW.NAPIERWATT.CO.UK

NAPIER WATT
PROPERTY CONSULTANTS